

**160-1081, Solder Terminal, Turreted, Feed Thru**

Recommended mounting hole .204 (5,18), #6 drill

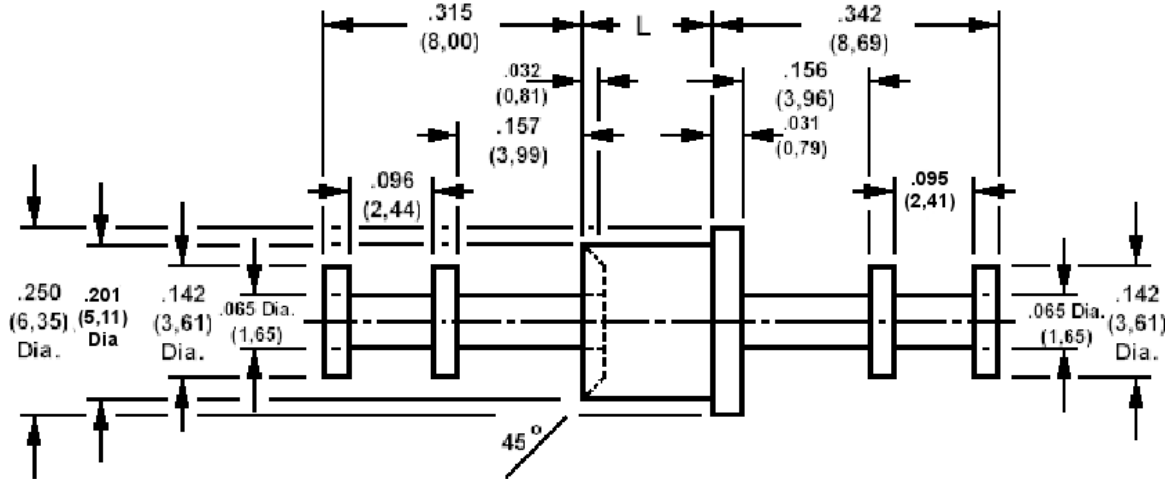

**How to order code**

**160-1081-XX-YY-00**

Basic Part No XX = L dimension, YY = Plating Finish

| DIMENSIONS (XX) |      |             |                 |
|-----------------|------|-------------|-----------------|
| Basic Part No   | (XX) | L           | Board Thickness |
| 160-1081        | -02  | .093 (2,36) | .062 (1,57)     |
|                 | -03  | .125 (3,18) | .094 (2,39)     |
|                 | -04  | .156 (3,96) | .125 (3,18)     |

| MATERIALS |          |             |                |
|-----------|----------|-------------|----------------|
| Component | Material | Finish (YY) |                |
| Terminal  | Brass    | -01         | -05            |
|           |          | Silver      | Electro Solder |

| SWAGE TOOLING               |                   |
|-----------------------------|-------------------|
| Recommended Swaging Tools:- |                   |
| Anvil                       | 435-6438-01-00-00 |
| Roll punch                  | 435-6606-01-00-00 |