

450-3289 Converter Socket, Insulated, .040 (1,02) Socket to .025 (0,64) Pin
 (Socket supplied without insulator, 450-3327)

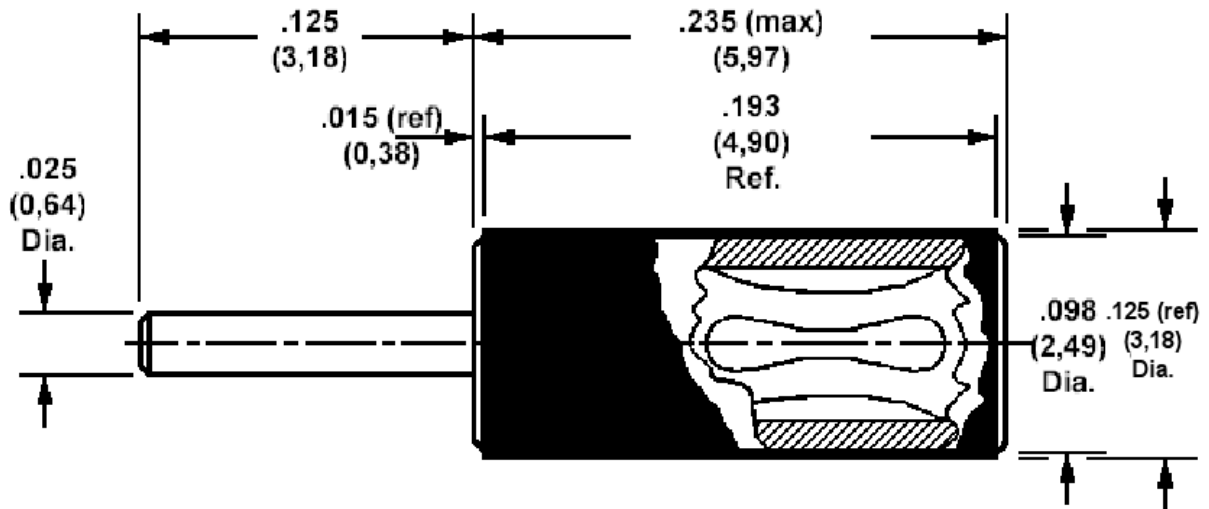

Min hole depth .190 (4,83)

How to order code
450-3289-01-03-10

Component	Material	Finish (-03)
Body	Brass	Gold over Nickel
Spring	Beryllium copper	Gold over Nickel
Insulator	Polyolefin plastic (black)	