

450-3721 Knurl Mount Socket, for .040 (1,02) Diameter Pins

Recommended mounting hole .089 (2,26) ± .001 (0,03), #43 drill

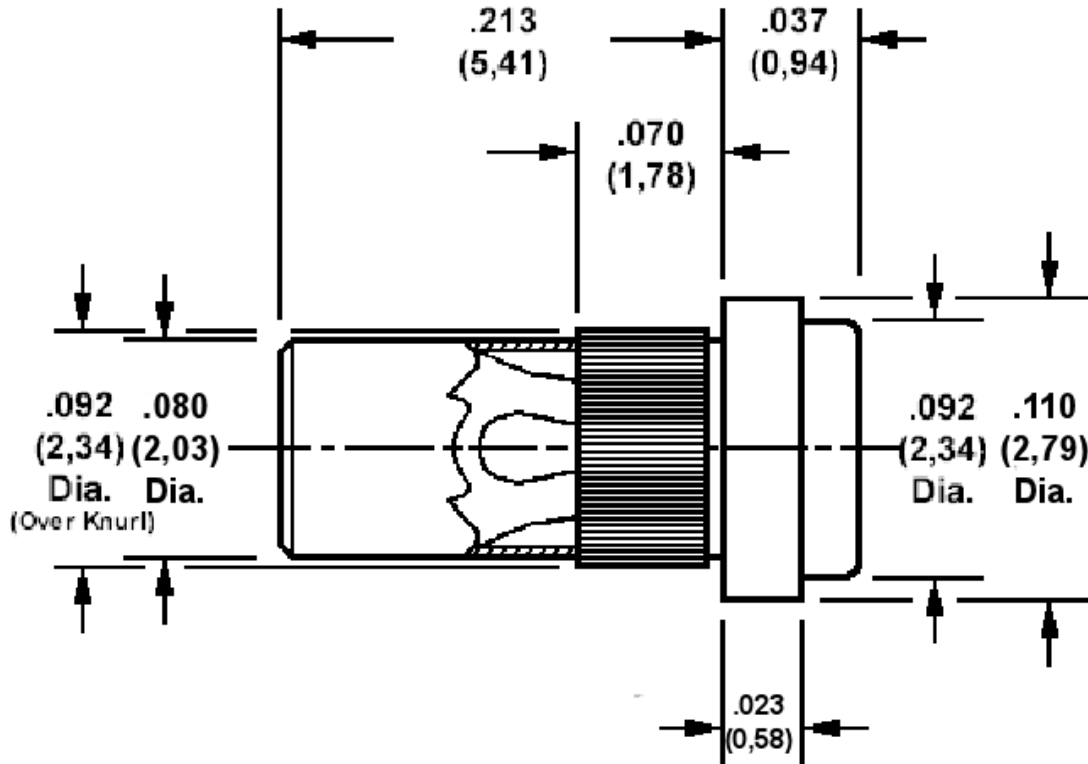

Min hole depth .185 (4,70)

How to order code
450-3721-01-XX-00
 Basic Part No XX = Finish

MATERIALS				
Component	Material	Finish (-03)	Finish (-04)	Finish (-06)
Body	Brass	Gold over Nickel	Electro Tin	Electro Tin
Spring	Beryllium copper	Gold over Nickel	Electro Tin	Gold over Nickel