

**460-3342 Swage Mount, .062 (1.57) Diameter Pin**

Recommended mounting hole .067 (1.70) ± .002 (0.05).

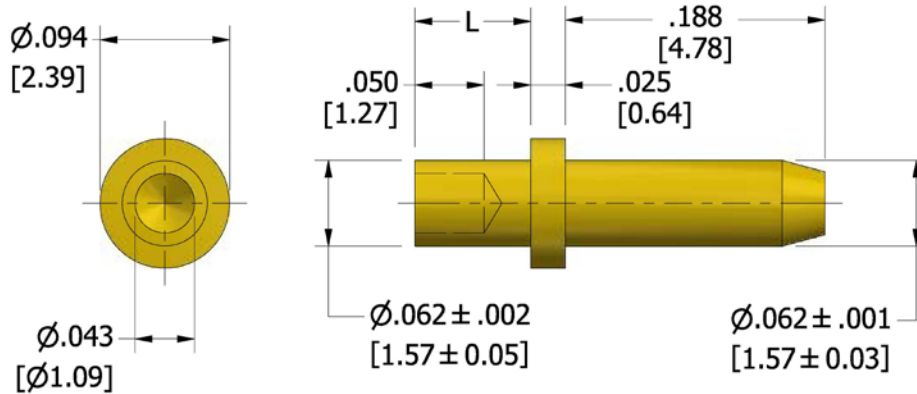

**How to order code**

**460-3342-XX-YY-00**

**Basic Part No XX = L dimension, YY = Plating Finish**

DIMENSIONS (XX)			
Basic Part Number	(XX)	L	Board Thickness
460-3342	-01	.053 (1,35)	.031 (0,79)
	-02	.084 (2,13)	.062 (1,57)
	-03	.115 (2,92)	.094 (2,39)

MATERIALS			
Component	Material	Finish (-03)	Finish (-04)
Pin	Brass	Gold over Nickel	Electro Tin

SWAGE TOOLING	
Recommended Swaging Tools:-	
Anvil	435-6411-01-00-00
Flare Punch	435-6657-01-00-00