

**460-8123 Swage Mount, .040 (1,02) Diameter Pin
 Non-Magnetic**

Recommended mounting hole .043 (1,09) ± .001 (0,03).

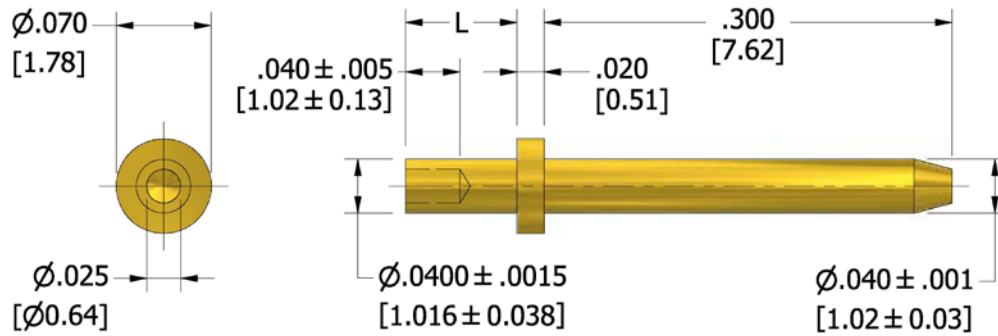

**How to order code
 460-8123-XX-YY-00**

Basic Part No XX = L dimension, YY = Plating Finish

DIMENSIONS (XX)			
Basic Part Number	(XX)	L	For Board Thickness
460-8123	-01	.051 (1,30)	.031 (0,79)
	-02	.082 (2,08)	.062 (1,57)
	-03	.113 (2,87)	.094 (2,39)

MATERIALS			
Component	Material	Finish (-03)	Finish (-04)
Pin	Brass, non-magnetic	Gold 0.75um over Copper	Electro Tin

SWAGE TOOLING	
Recommended Swaging Tools:-	
Anvil	435-6468-01-00-00
Roll Punch	435-6642-01-00-00
Flare Punch	435-6690-01-00-00

Dimensions in inches [mm]
 Tolerance unless otherwise stated ±.003 [0.08]