

## 571-4028 Insulated solder terminal, Turreted

Recommended mounting hole .136 (3,45)

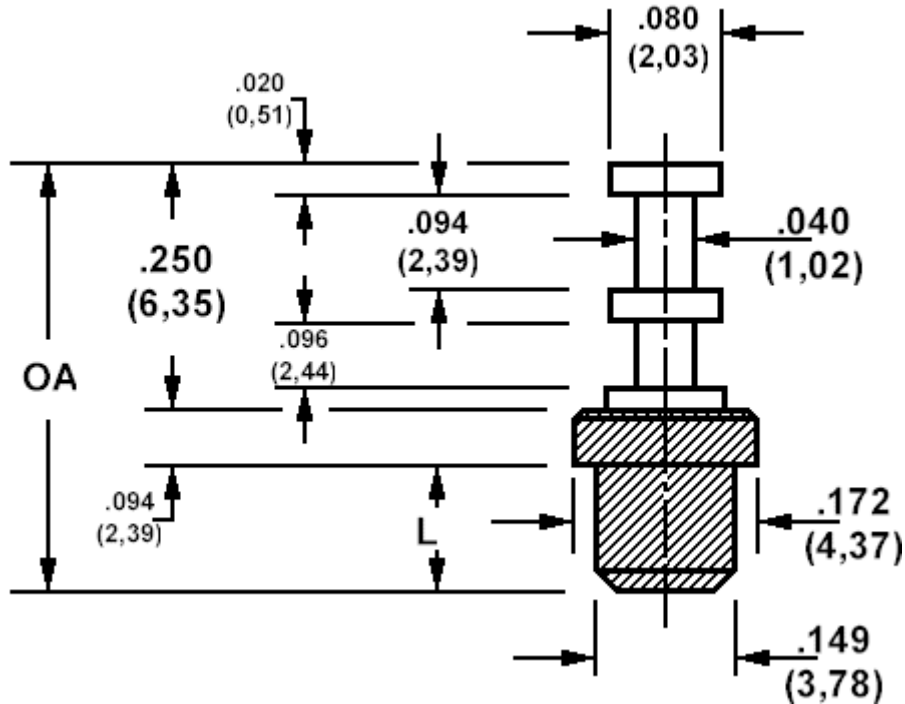

### How to order code

**571-4028-XX-YY-19**

Basic Part No (XX = Panel thickness, YY = plating finish. See tables for options)

Basic Part No.		OA (ref)	L	Panel Thickness (XX)
571-4028	-01	.444 (11,28)	.100 (2,54)	.031 (0,79) to .062 (1,59)
	-02	.469 (11,91)	.125 (3,18)	.031 (0,79) to .085 (2,16)
	-03	.509 (12,93)	.165 (4,19)	.031 (0,79) to .125 (3,18)
	-04	.594 (15,09)	.250 (6,35)	.031 (0,79) to .210 (5,33)

Component	Material	Finish (YY)	
		-01	-05
Terminal	Brass	Silver	Electro Solder
Insulator	Teflon - white		

Additional Specifications	Panel thickness			
	-01	-02	-03	-04
Flashover VRMS at Sea Level	4200	4200	4200	4200
Capacitance (pF)	0.5	0.5	0.5	0.6

Teflon is a registered trademark of Dupont