

703-8070 11 Way (9+2) Relay Base

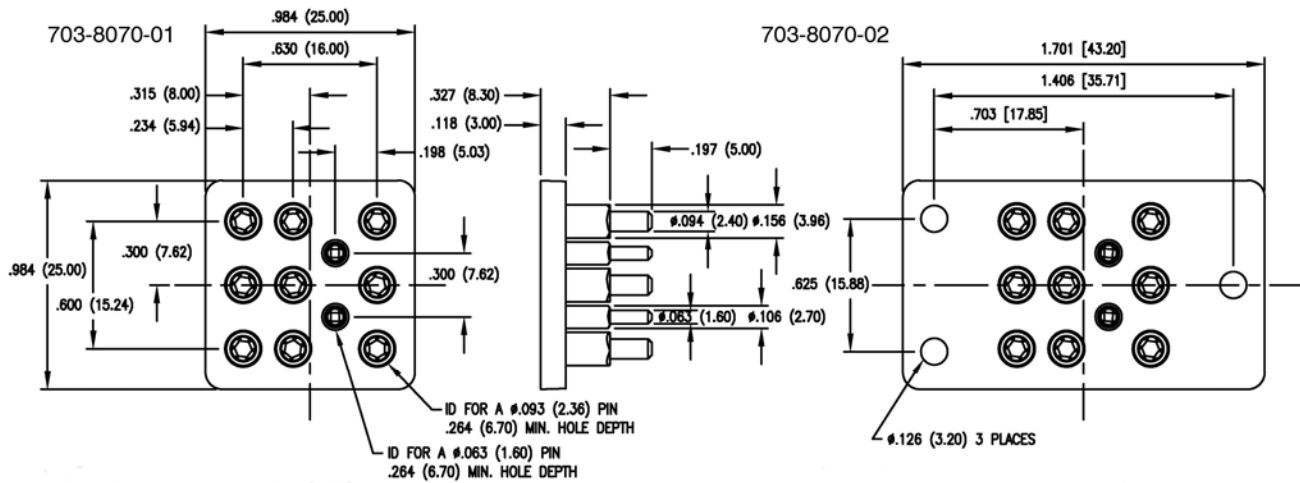

How to order code

703-8070-XX-03-10

Basic Part No XX = mounting ear option

Two styles of base available to suit round pin format Relays, with and without mounting ears for optimum location possibilities. Relay base pins solder directly to PCB to maintain correct pitch for ease of Relay insertion.

Mounting Ear Option (XX)		
	(XX)	Option
703-8070	-01	With out
	-02	With mounting ears

MATERIALS		
Component	Material	Finish
Carrier	High Temperature Plastic	
Socket Bodies	Brass, EN 12164, CuZn36Pb3	Gold Plate 0.25µM, Nickel 1.25µM over Copper flash
Socket Clips	Beryllium Copper, Alloy 172, HT.	Gold Plate 0.75µM, Nickel flash

Other styles and configurations available please consult factory

RoHS Compliant