

**450-3718 Solder Mount Socket,
 for .030 (0,76) to .032 (0,81) Diameter Pins**

Recommended mounting hole .076 (1,93) + .002 (0.05), - .001 (0,05), #48 drill

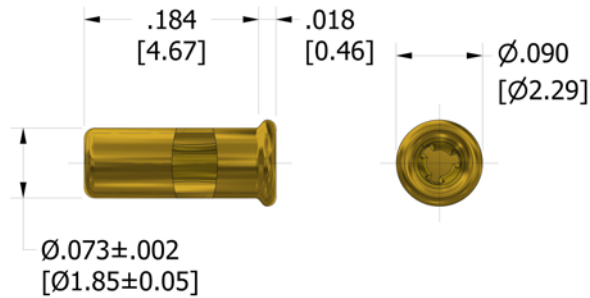

Min hole depth .190 (4,83)

How to order code
450-3718-01-XX-00
Basic Part No XX = Finish

MATERIALS				
Component	Material	Finish (-03)	Finish (-04)	Finish (-06)
Body	Copper	Gold over Nickel	Electro Tin	Electro Tin
Spring	Beryllium copper	Gold over Nickel	Electro Tin	Gold over Nickel



Dimensions in inches [mm]
 Tolerance unless otherwise stated $\pm .005$ [0.13]